

How to add an accordion menu

1. Create a new **Folder** asset

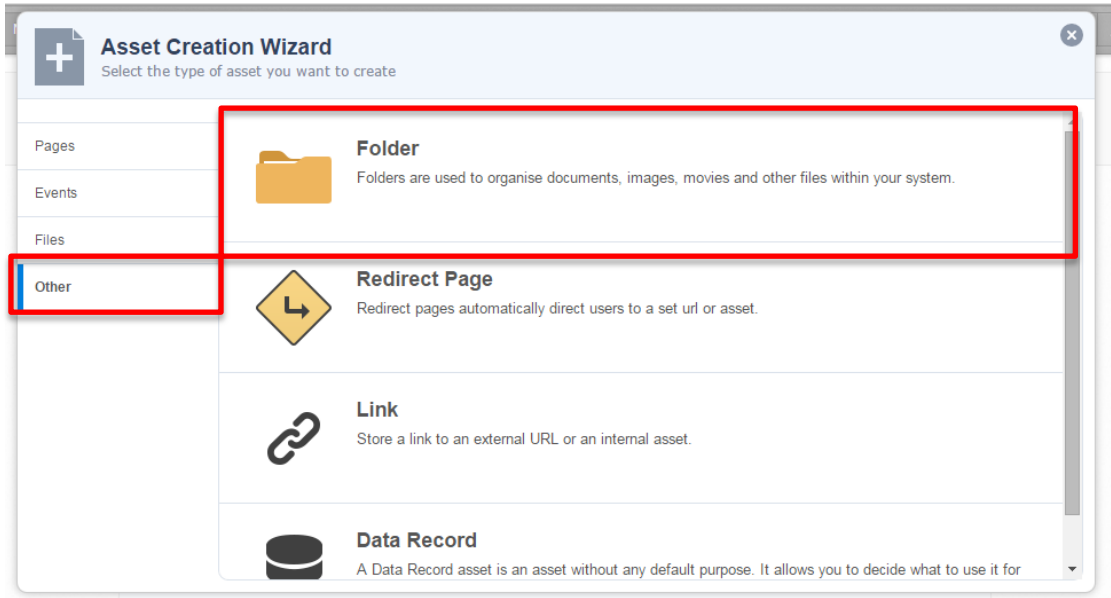

2. Enter the details

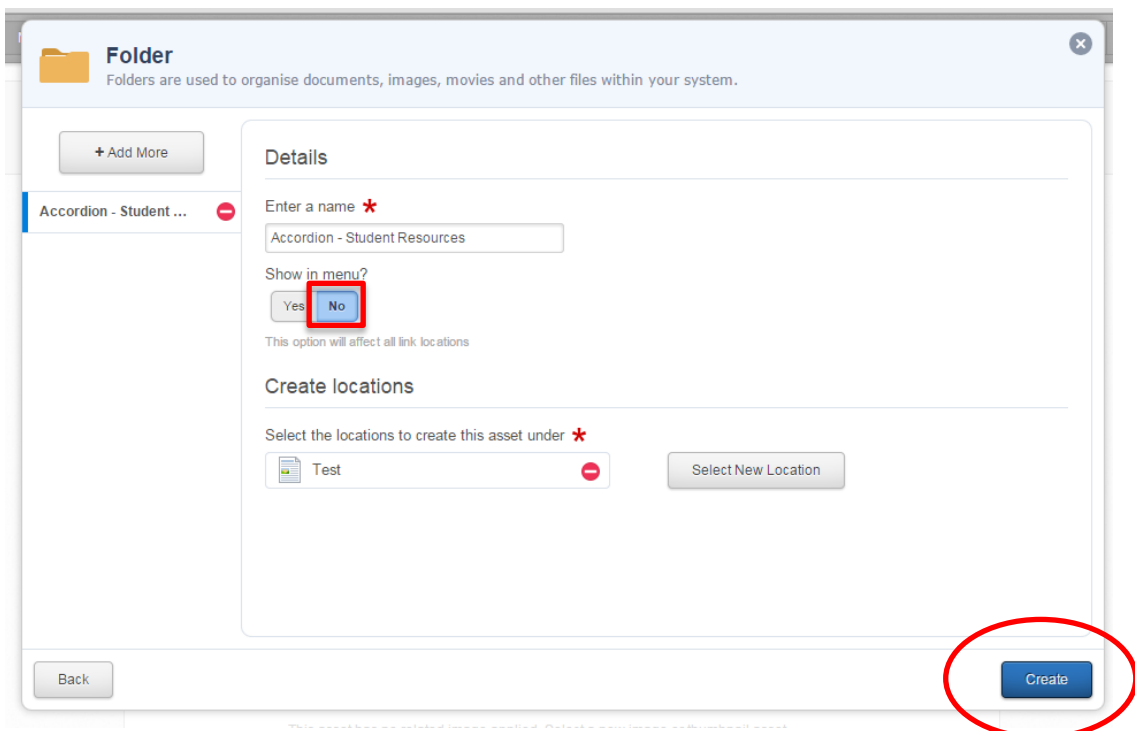

- a) Enter a name – this doesn't show up on your page anywhere.
 - b) Select **No** to *Show in menu*
 - c) Select the page you would like to put the accordion on as the Location.
 - d) Select **Create**
3. Select **Edit** your Accordion folder asset and go to the **New asset** tool.

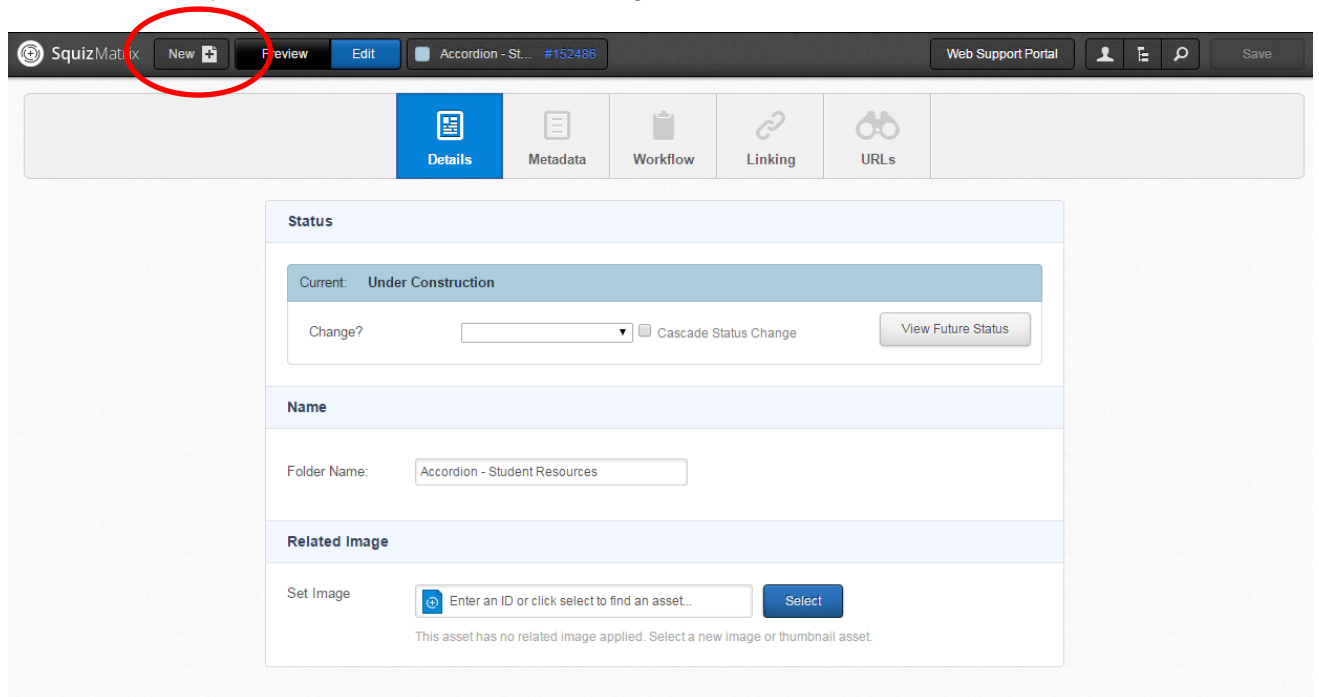

4. Create as many **Standard Page** assets as you need to drop down in your accordion - and save them all in your accordion folder. Each drop-down section in an accordion is a **Standard Page** asset and the heading is the name of the page asset.

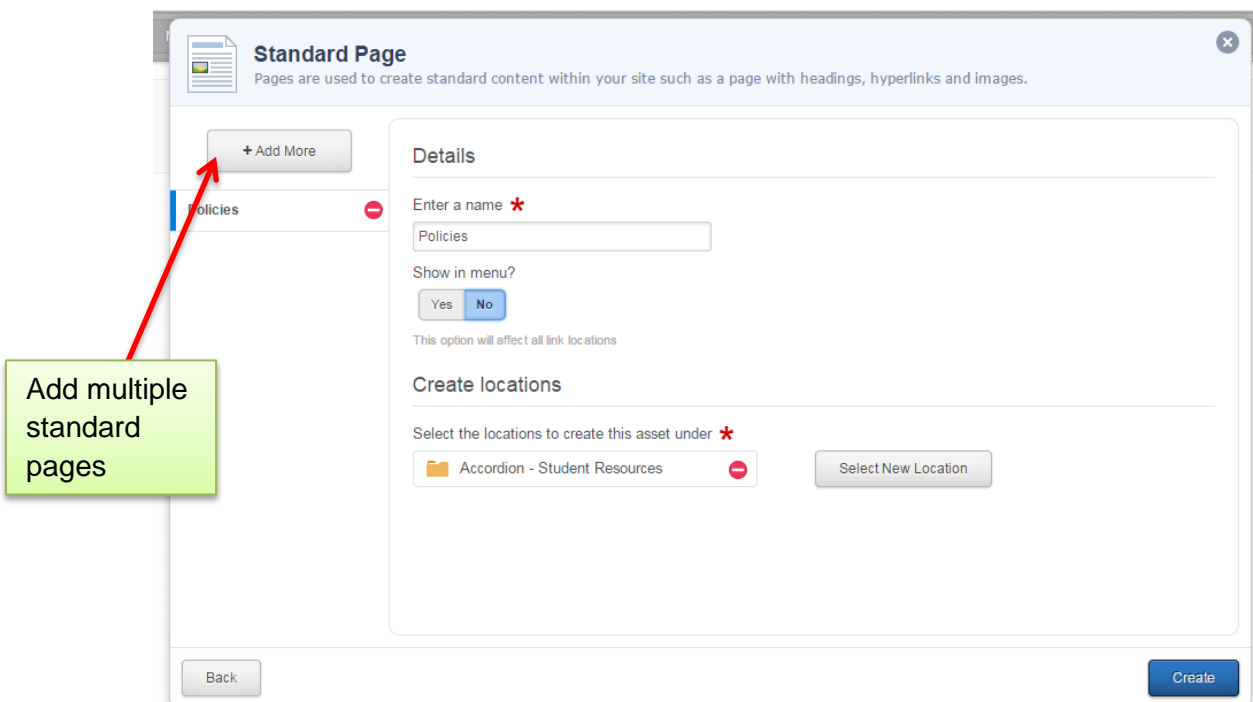

5. Select **Edit** your Standard Page asset

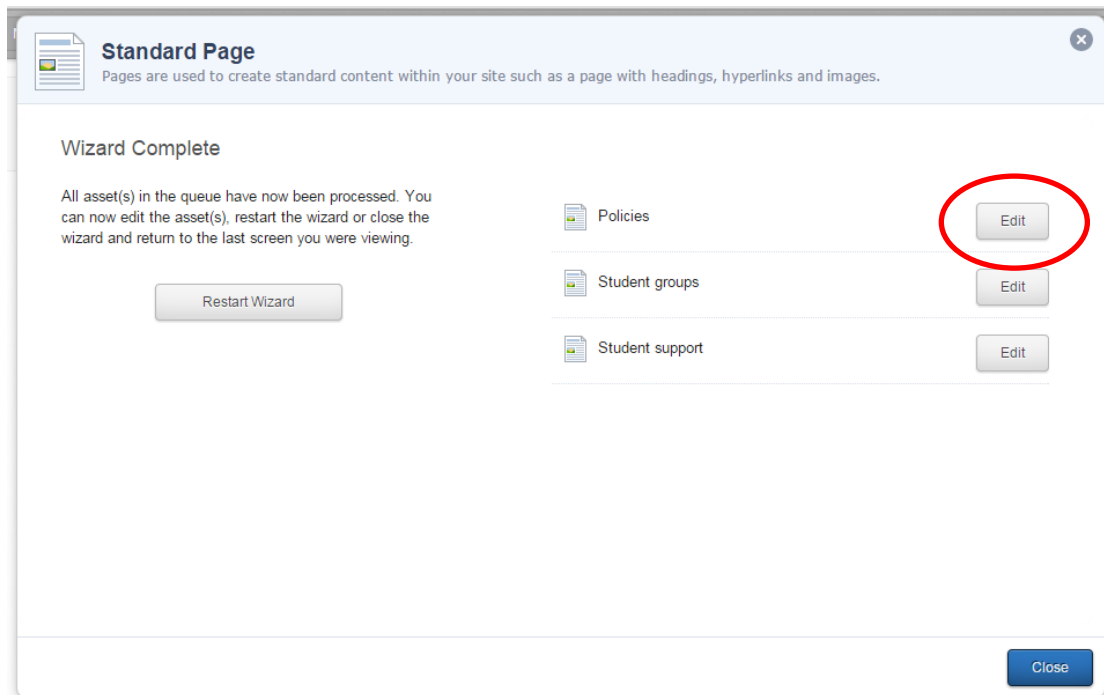

6. Add the content you would like under the page heading.

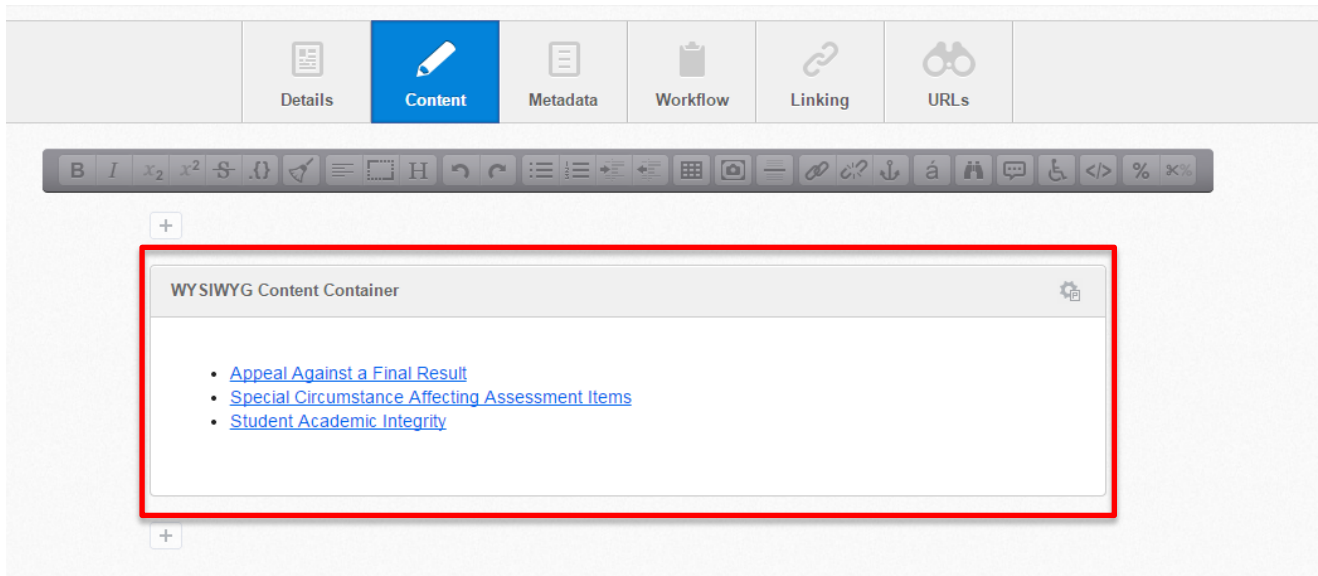

7. Once you have finished adding all the content to your *Standard Page* assets in your *Accordion* folder, go to the **Asset Finder** and Select the **Standard Page** asset you would like to put the accordion on.

8. Insert a **New Container** by going to the plus sign at the top or bottom (depending on where you want your accordion) left-hand side of your *WYSIWYG Content Container*.

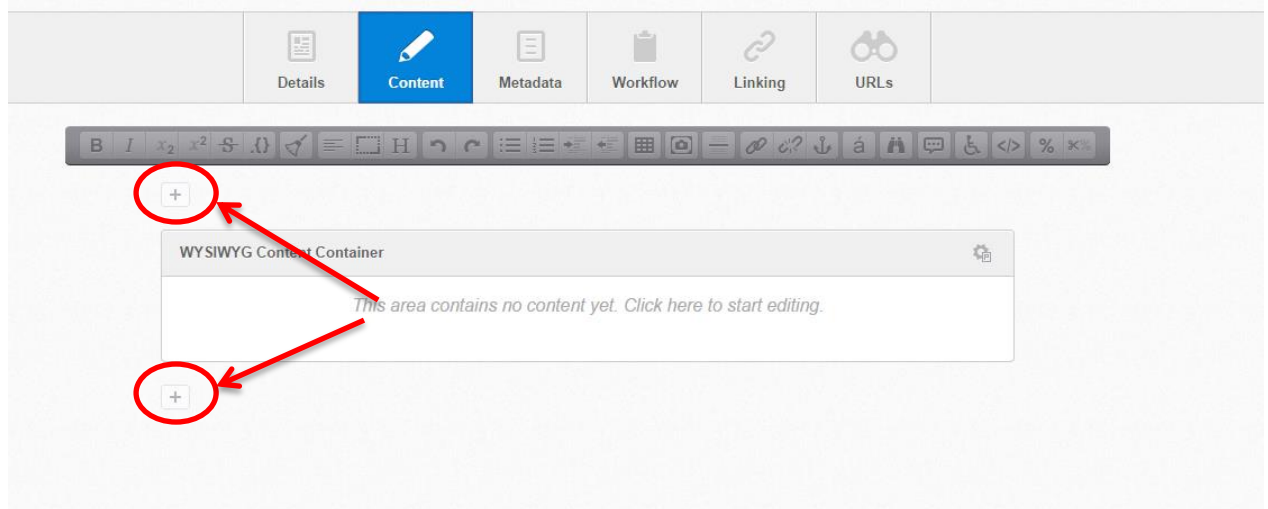

9. Change the *Styling Presentation* of the container to **RAW HTML** and the *Content Type* to **Nested Content** – and click **Insert**.

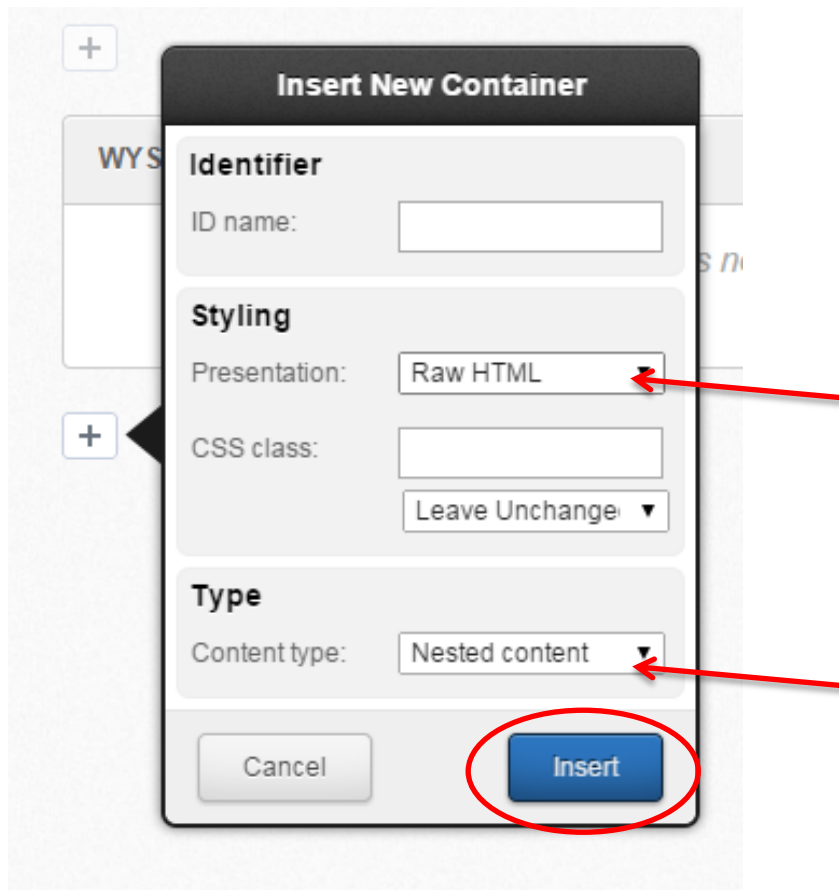

10. In the *Nested Content Container* Select your accordion folder asset.

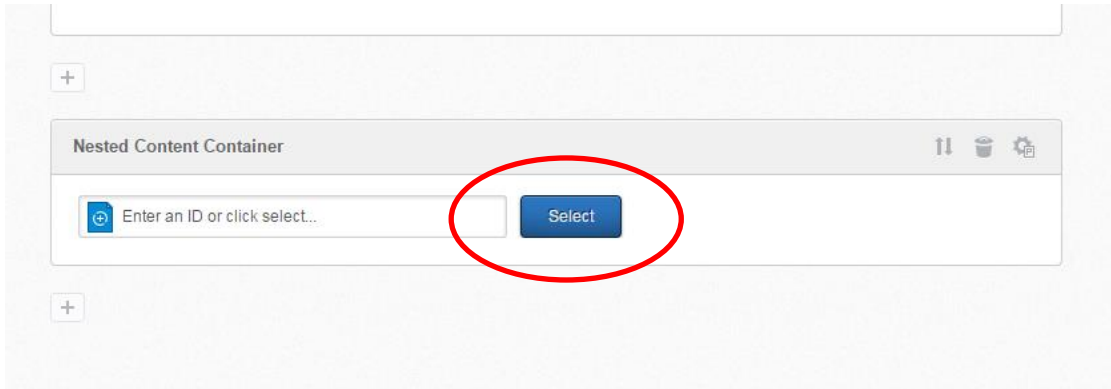

11. Once you have selected your accordion folder, select **Save** and a **Show Additional Options** button will appear – Select this.

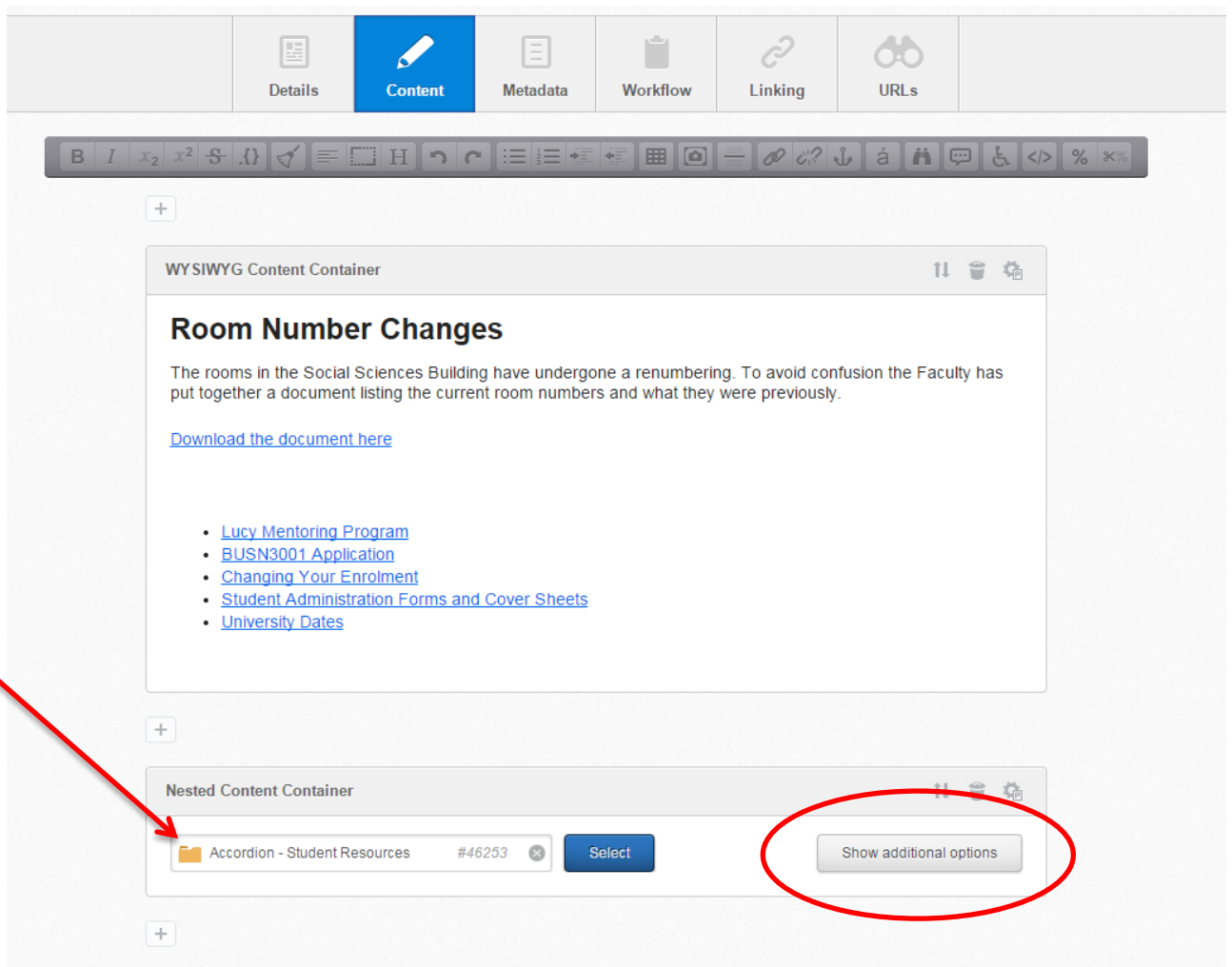

12. Go to the *Paint Layouts* section and **Select from a List of Predefined Paint Layouts**, and Select the **Accordion** Paint Layout. And then **Save**.

The screenshot shows the 'Nested Content Container' configuration interface. At the top, there is a search bar containing 'Accordion - Student Resources' with an ID of '#46253' and a 'Select' button. Below this is a 'Dynamic Options' section with a text area for 'GET variable name'. The 'Paint Layouts' section is highlighted with a red box and contains a dropdown menu labeled 'Select from a list of predefined Paint Layouts' which is currently set to 'Accordion'. Below this is an 'Additional GET Parameters' section with a table for 'Name' and 'Value' and an 'Add new variable...' button.

13. Now you can **Preview** your accordion

